



ECOPHON FOCUS™ FRIEZE

For applications where a smooth continuous transition between the ceiling and the wall is needed. The frieze can be connected to the wall without any visible trims. The tiles are not demountable.

The system consists of Ecophon Focus frieze tiles and Ecophon Connect grid systems, with an approximate weight of 3 kg/m². The tiles are manufactured from high density glass wool. The visible surface has an Akutex™ FT coating and the back of the tile is covered with glass tissue. The edges are painted.

For best performance and system quality, use Ecophon Connect grid and accessories. The grid is manufactured from galvanized steel.

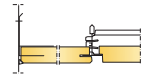

Focus frieze system

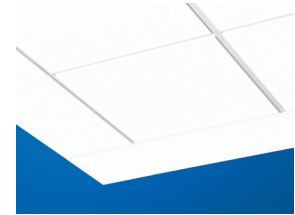

Focus frieze system

SYSTEM RANGE

Size, mm		
	2400 x 600	2400 x 600
T24	•	•
Thickness	20	20
Inst. Diagr.	M239	M110

TECHNICAL PROPERTIES

ACOUSTIC Sound Absorption Test results according to EN ISO 354. Classification according to EN ISO 11654, and the single value ratings for NRC and SAA according to ASTM C 423.

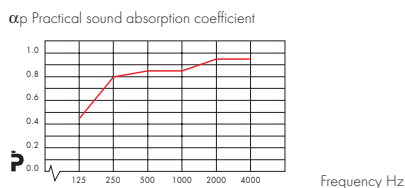

Product	Focus Frieze
o.d.s mm	200
absorption class	A
NRC	
SAA	
α_w	

Sound Insulation $D_{st,w}$ =24 dB according to ISO 140-9 and evaluation according to EN ISO 717-1. CAC=25 dB according to ASTM E 1414 and evaluation according to ASTM E 413.

Sound Privacy AC(1.5)=190 according to ASTM E 1111 and E 1110.

ACCESSIBILITY The tiles are not demountable.

CLEANABILITY Daily dusting and vacuum cleaning. Weekly wet wiping.

VISUAL APPEARANCE White Frost, nearest NCS colour sample S 0500-N, 85% light reflectance (of which more than 99% is diffuse reflection). Retro reflection coefficient 63 mcd*m⁻²lx⁻¹. Gloss < 1.

INFLUENCE OF CLIMATE The tiles withstand a permanent ambient RH up to 95% at 30°C without sagging, warping or delaminating (ISO 4611).

INDOOR CLIMATE Certified by the Indoor Climate Labelling, recommended by the Swedish Asthma and Allergy Association, and can be used in rooms classified as ISO class 6 according to ISO 14644-1.

ENVIRONMENTAL INFLUENCE Granted the Nordic Swan eco-label. Fully recyclable.

FIRE SAFETY The glass wool core of the tiles is tested and classified as non-combustible according to prEN ISO 1182. The systems are classified as fire protective covering according to NT FIRE 003. See Technical properties, Fire safety.

Reaction-to-fire classification

Country	Standard	Class
Europe	EN 13501-1	A2-s1,d0

MECHANICAL PROPERTIES For information regarding live load and requirements for load bearing capacity, see installation diagrams. Conditions: See Functional demands, Mechanical properties.

INSTALLATION Installed according to system range which includes information regarding minimum overall depth of system.

INSTALLATION DIAGRAM (M110) FOR FOCUS FRIEZE

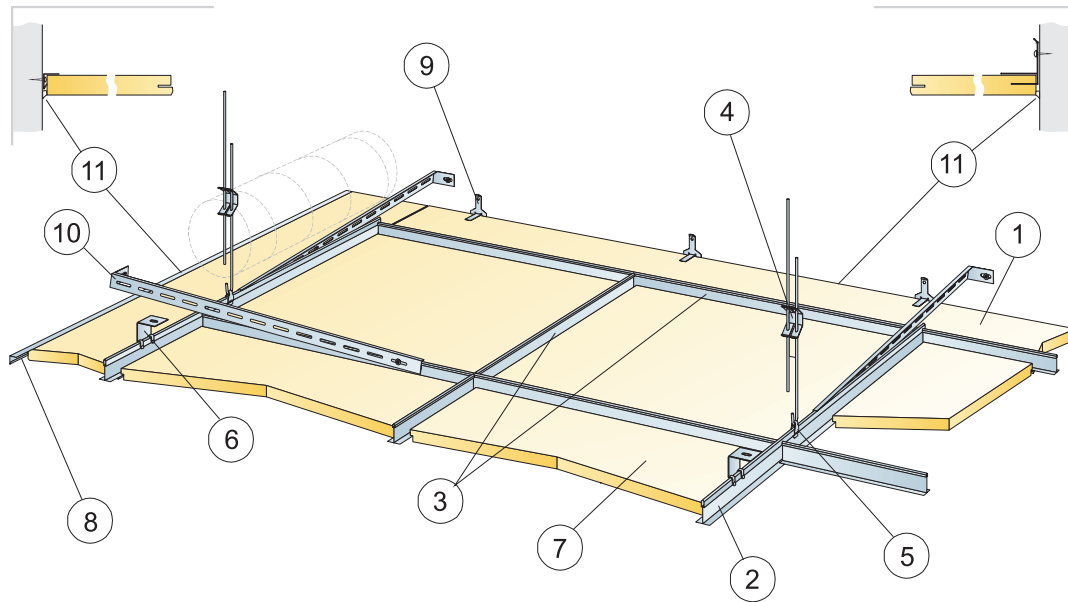

© Ecophon Group

QUANTITY SPECIFICATION (EXCL. WASTAGE)

	Size, mm
	2400x600
1 Ecophon Focus Frieze	as required
2 Connect T24 Main runner	as required
3 Connect T24 Cross tee, L=600 mm	as required
4 Connect Adjustable hanger, installed at 1200 mm centres	as required
5 Connect Hanger clip	as required
6 Connect Direct bracket (only in combination with Frieze trim)	as required
7 Focus A or E, Master A or E	as required
8 Connect Frieze trim, fixed at 300 mm centres. If this solution is used on two opposite walls, the inner part if the ceiling needs to be stabilized towards the walls. Minimum free depth above tile 0 mm.	as required
9 Connect Frieze bracket, installed at 500 mm centre. Minimum free depth above tile 150 mm.	/cut tile with one bearing edge
10 Connect Wall bracket, L=600 mm, for distance profiles	as required
11 Acrylic sealant, (not supplied by Ecophon)	as required
Δ Min. overall depth of system: with Adjustable hanger: 110 mm, with Direct bracket: 60 mm	-
δ Min. demounting depth: The system is not demountable	-
Focus Frieze: Min. overall depth of system: 160 mm	-
Focus Frieze: Min. demounting depth: The system is non-demountable	-
Ecophon Focus frieze: can be divided in two parts if width is less than 300 mm	

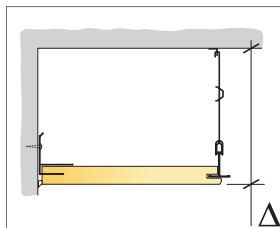

See Quantity specification

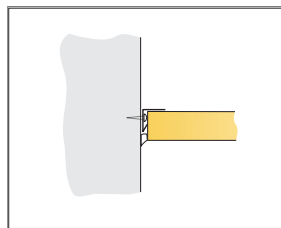

Fixing with frieze trim

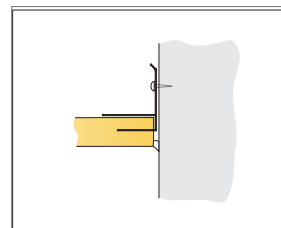

Fixing with frieze bracket

Size, mm	Max live load [N]	Min load bearing capacity [N]
2400x600	0	160

Live load/load bearing capacity

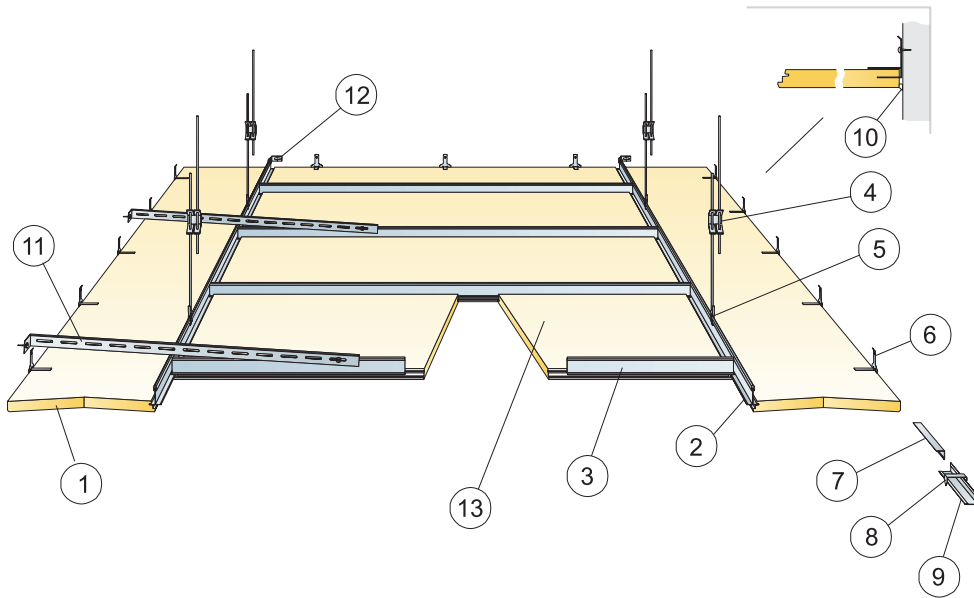

© Ecophon Group

QUANTITY SPECIFICATION (EXCL. WASTAGE)

		Size, mm
		2400x600
1	Ecophon Focus frieze Ds/Dg	as required
2	Connect T24 Main runner	as required
3	Connect T24 Cross Tee L=600/1200/1800 alt. Main runner	as required
4	Connect Hanger clip	as required
5	Connect Adjustable hanger, installed at 1200 mm centres	as required
6	Connect Frieze bracket, installed at 500 mm centre. Minimum free depth above tile 150 mm.	/cut tile with one bearing edge
7	Connect Frieze trim, fixed at 300 mm centres.	as required
8	Connect Perimeter tile clip	1 /300-400mm on any cut edge
9	Connect Angle trim	as required
10	Acrylic sealant, (not supplied by Ecophon)	as required
11	Connect Wall bracket, L=600 mm, for distance profiles	as required
12	Connect Wall bracket for T-profiles	as required
13	Ecophon Focus Ds or Dg	as required
Δ Min. overall depth of system: 110 mm		-
δ Min. demounting depth: Focus frieze tiles are non-demountable, center part according to each system		

Ecophon Focus frieze: can be divided in two parts if width is less than 300 mm

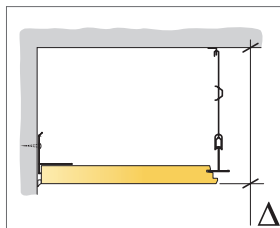

See Quantity specification

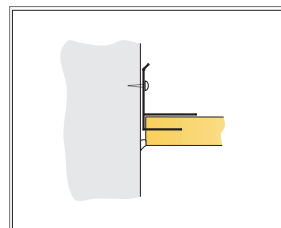
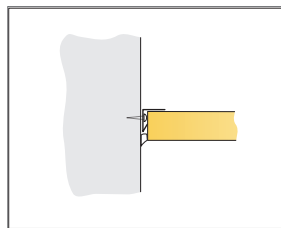

Size, mm	Max live load [N]	Min load bearing capacity [N]
2400x600	0	160

Live load/load bearing capacity