



ECOPHON HYGIENE FOODTEC™ WALL C3



Ecophon Hygiene Foodtec Wall C3 is a sound-absorbing wall panel system intended for use in environments where there is risk of contamination, and where frequent cleaning is required. It is intended for use on walls above the occupied area or where there is no risk for mechanical impact. Examples of applications: the food and beverage industries, restaurants and catering kitchens.

The system consists of Ecophon Hygiene Foodtec Wall panel, which has a core of high density glass wool and a painted stain protected Akutex HS surface on both sides. The edges are painted. The fixing details Connect Wall fixing C3 are made of stainless steel wire. The panel is positioned with an airgap of 40 mm to the surface behind allowing for air to circulate and for cleaning. The weight of the system is approximately 3 kg/pcs.



Hygiene Advance Wall



Hygiene Advance Wall C3 system



Connect Wall fixing C3



SYSTEM RANGE

Size, mm	1200 x 600
Special Fixing	•
Thickness	40
Inst. Diagr.	M262

TECHNICAL PROPERTIES

ACOUSTIC Sound Absorption Test results according to EN ISO 354. Classification according to EN ISO 11654.

α_p Practical sound absorption coefficient

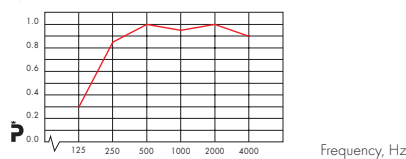

– Ecophon Hygiene Foodtec Wall C3, 80 mm o.d.s.

(refers to the surface of the panel)

o.d.s= overall depth of system

Product	Hygiene Foodtec Wall C3
o.d.s mm	80 (refers to the surface of the panel)
absorption class	A

Sound Insulation Not applicable.

Sound Privacy Not applicable

ACCESSIBILITY The tiles are demountable.

CLEANABILITY Daily dusting and vacuum cleaning. Weekly wet wiping on all surfaces, high-pressure washing and wet cleaning twice a year (water temperature max. 35°C). Steam cleaning four times/year. Can withstand the use of common disinfecting chemicals.

VISUAL APPEARANCE White 500, nearest NCS colour sample S 0500-N, 84% light reflectance.

INFLUENCE OF CLIMATE The tiles withstand a permanent ambient RH up to 95% at 30°C without sagging, warping or delaminating (ISO 4611). A higher temperature/moisture is permissible during washing as stated above. The grid and accessories meet the demands of corrosion class C3 according to EN ISO 12944-2. For the microbiological resistance see Functional demands, Influence of climate.

INDOOR CLIMATE Certified by the Indoor Climate Labelling, emission class M1 for building materials, recommended by the Swedish Asthma and Allergy Association, and can be used in rooms classified as ISO class 5 according to ISO 14644-1.

ENVIRONMENTAL INFLUENCE Granted the Nordic Swan eco-label. Fully recyclable.

FIRE SAFETY The glass wool core of the tiles is tested and classified as non-combustible according to EN ISO 1182. See Functional demands, Fire safety.

Reaction-to-fire classification

Country	Standard	Class
Europe	EN 13501-1	A2-s1,d0

MECHANICAL PROPERTIES For information regarding live load and requirements for load bearing capacity, see installation diagrams. Conditions: See Functional demands, Mechanical properties.

INSTALLATION Installed according to system range which includes information regarding minimum overall depth of system.

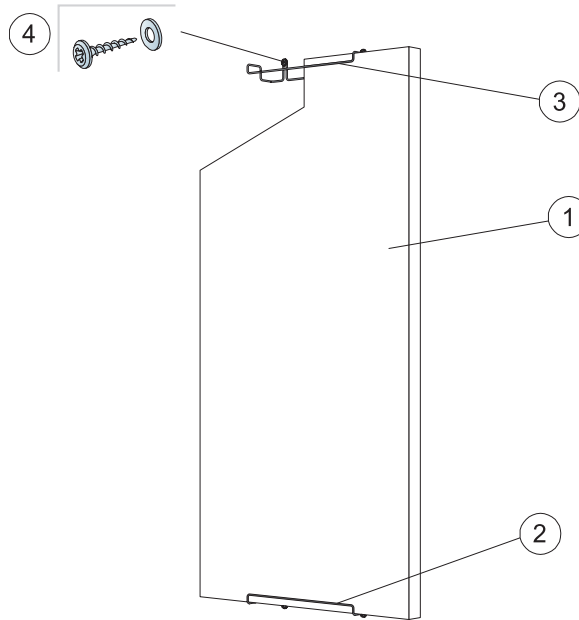

© Ecophon Group

QUANTITY SPECIFICATION (EXCL. WASTAGE)

		Size, mm
		1200x600
1	Ecophon Hygiene Foodtec Wall	1,4/m ²
2	Connect Wall fixing C3, vertical installation	2/panel
3	Connect Wall fixing C3, horizontal installation	4/panel
4	Wall screw, A2 material (not supplied by Ecophon)	2/wall fixing

Δ Min. overall depth of system: 90 mm

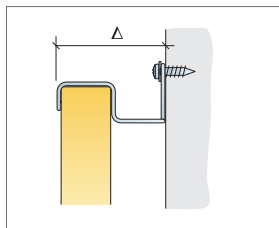

See Quantity specification

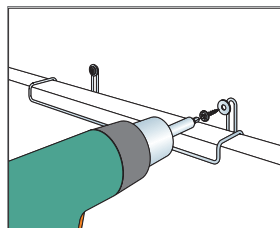

Installation with wall screw in A2 material

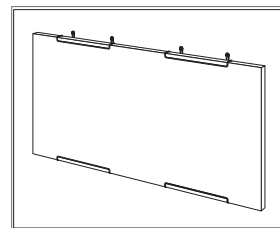

Horizontal installation of Foodtec Wall C3

Size, mm	Max live load [N]	Min load bearing capacity [N]
1200x600	0	-

Live load/load bearing capacity